

Point of Use Series | UF



UF-216CC

Antunes offers systems that remove almost all suspended particles from the water, which yields filtered water for point-of-use applications and fewer maintenance issues related to poor water quality.

The UF-216CC uses a self-cleaning ultrafiltration cartridge ahead of a low-cost carbon cartridge to separate mechanical filtration from taste and odor reduction. The ultrafiltration cartridge reduces almost all particles as small as .015 microns, substantially reducing microbiological contaminants and providing healthy drinking water, while the carbon cartridge removes chlorine and objectionable tastes. The unit's self-cleaning ability extends the life of the cartridges and allows the system to operate with very little user intervention.

NOTE: TAC systems available for scale reduction.

FEATURES

- .015 micron ultrafiltration removes almost all suspended particles, assuring consistent high-quality water.
- Self-cleaning capabilities assure long time between cartridge changes.
- Microbiological reduction provides healthy drinking water.
- Carbon cartridge removes chlorine and objectionable tastes.
- Operation simplicity.
- Small footprint makes system ideal for point-of-use applications.

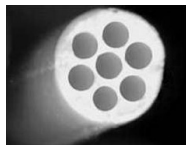

Multi-Bore
Ultra Filtration Membrane

Point of Use Series | UF

Dimensions

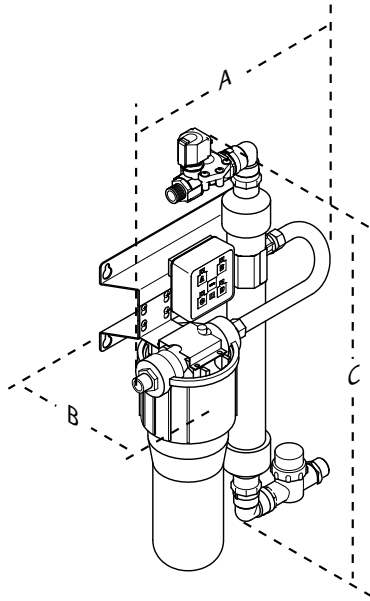

Model & Mfg. No.	Width (A)	Depth (B)	Height (C)
UF-216CC 9700407	14" (36 cm)	7" (18 cm)	26" (66 cm)

Electrical Ratings and Plug Configurations

Model & Mfg. No.	Volt	Watts	Amp.	Hz.	Plug Configuration
UF-216CC 9700407	100-240	10	0.8	50/60	Includes adaptors for US, Europe, Australia and UK

Capacities

Model & Mfg. No.	Capacity Per Minute
UF-216CC 9700407	1.5 gal. (5.8 liters)

Plumbing Connections

Model & Mfg. No.	Inlet	Outlet	Drain
UF-216CC 9700407	1/2" NPT	1/2" NPT	1/2" NPT

Specifications (Ultra Filter)

Maximum Operating Pressure	100 psig (690 kPa)
Maximum Operating Temperature	104°F (40°C)
Nominal Pore Size	.015 microns
pH Range	3-10
MWCO	100 kD

P/N 1020412 02/19